

LONG SECTION: Road 2
 SCALE: H:500, V:100
 DATUM: 205.00

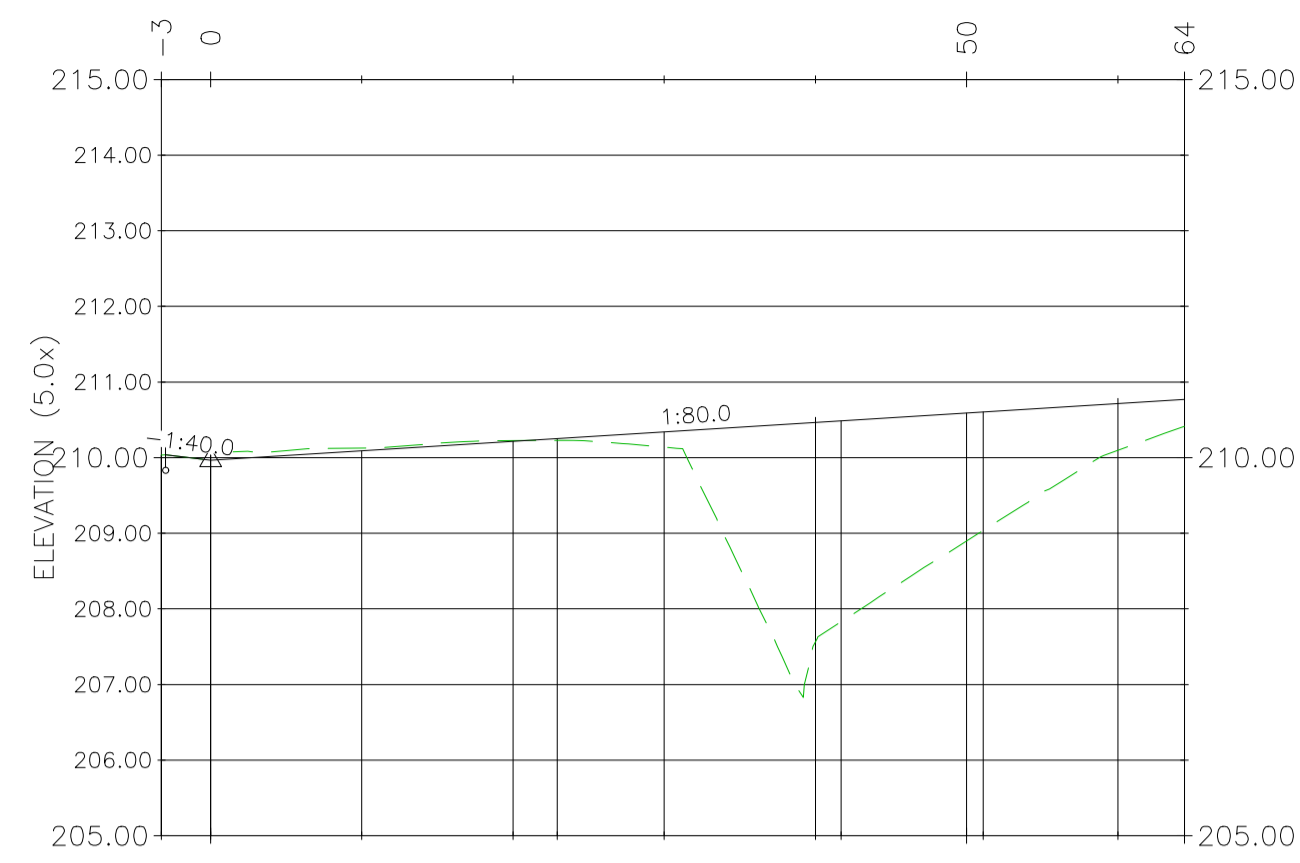

CHAINAGE	H: 2.99 V: 13.250	0.000	10.000	20.000	22.915	30.000	40.000	41.695	50.000	60.000	64.403
HORIZONTAL GEOMETRY	L:3.3	L:22.9	R:84.0 L:18.8	L:9.4	R:100.0 L:13.5						
VERTICAL GEOMETRY	G:-1:40.0 (-2.5%) L:3.0					G:1:80.0 (1.2%) L:64.4					
EXISTING LEVELS	209.964	210.124	210.223	210.139	207.563	208.897					
FINISHED LEVELS	H: 210.039 V: 209.209,964	210.089	210.214	210.251	210.339	210.464	210.485	210.583	210.714	210.769	

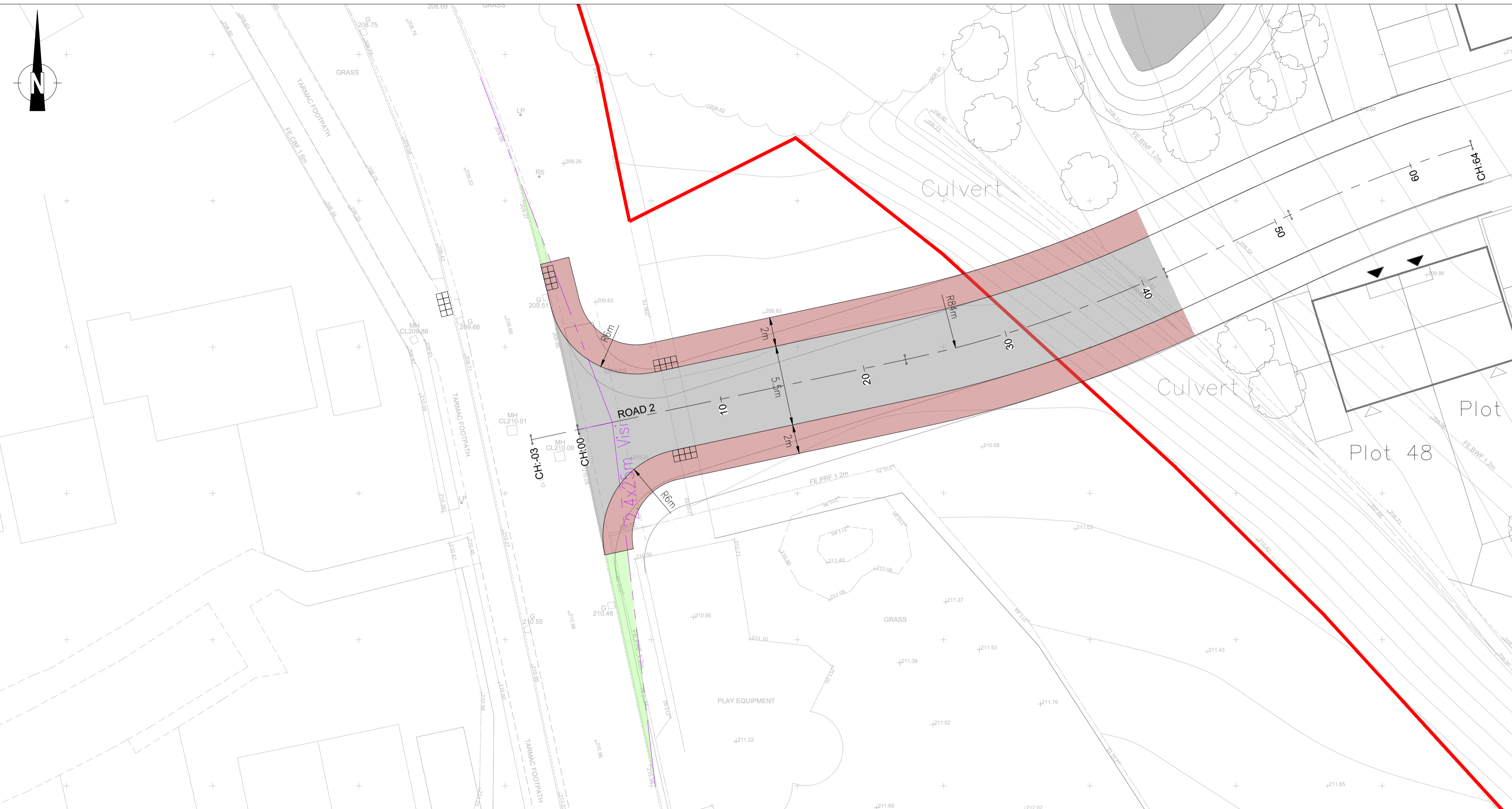

Legend:

	Major Access Road - Bituminous
	Footway - Bituminous
	Verge
	Site boundary

AWAITING TECHNICAL APPROVAL
 This drawing has NOT been technically approved by Local Authority and/or Water Authority. All works subject to change through technical review process with relevant approving authorities.

- SAFETY, HEALTH AND ENVIRONMENTAL INFORMATION**
- PLEASE REFER TO THE HEALTH AND SAFETY FILE FOR A FULL LIST OF THE HAZARDS ASSOCIATED WITH THIS WORK - THE FOLLOWING ARE THE MOST SIGNIFICANT ITEMS TO BE AWARE OF.
- CONSTRUCTION**
- OPERATIVES TO TAKE PRECAUTIONS WHEN WORKING ADJACENT TO OR WITHIN DEEP EXCAVATIONS. METHOD STATEMENT TO BE PRODUCED BY CONTRACTOR PRIOR TO WORKS COMMENCING.
 - ATTENTION IS DRAWN TO THE EXISTENCE OF BOTH EXISTING UNDERGROUND AND OVERHEAD UTILITIES.
- ENVIRONMENTAL**
- EXISTING WATERCOURSES IN CLOSE PROXIMITY TO WORKS. A POLLUTION PREVENTION STRATEGY AND WORKING METHOD STATEMENTS TO BE PRODUCED BY THE CONTRACTOR FOR ALL WORKS.
 - CONSIDERATION GIVEN TO NOISE LEVELS GIVEN PROXIMITY TO EXISTING PROPERTIES.
 - CONSIDERATION GIVEN TO GROUND CONDITIONS. CONTRACTOR TO REVIEW GEOTECHNICAL REPORT PRIOR TO UNDERTAKEN EXCAVATION WORKS.
- WORK CAN ONLY BE CARRIED OUT BY SUITABLY TRAINED AND BRIEFED PERSONNEL.

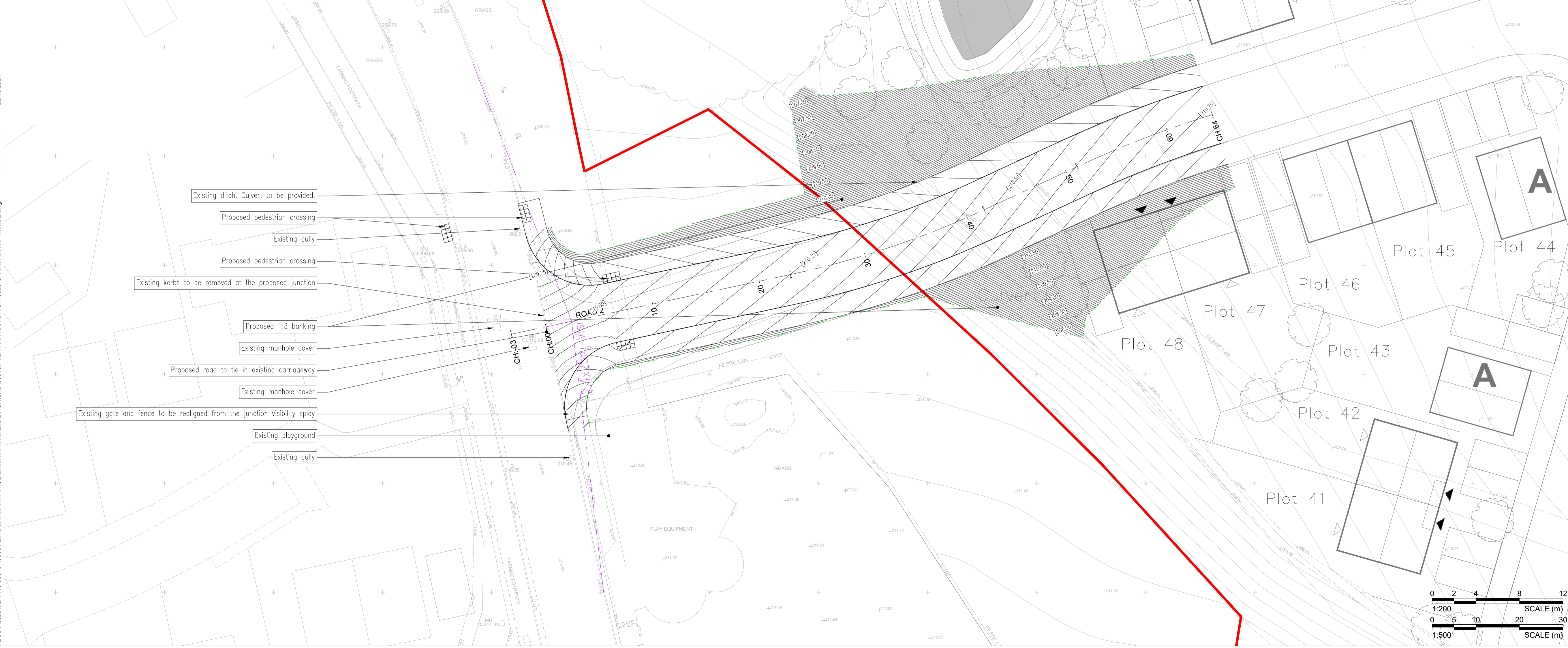

P01	First issue	28.10.24	PB	JAK	JAK
Rev	Amendments	Date	By	Chk	Auth

SLR
 www.slrconsulting.com

FOR INFORMATION S2

Client: REG KNILL

Project: LAND AT TREMONT PARK LLANDRINDOD WELLS

Drawing Title: SITE ACCESS PLAN GENERAL ARRANGEMENT ROAD 2

Scale: 1:200	@ A1	SLR Project No: 416.065167.00000
Designed: PB	Drawn: PB	Checked: JAK
Date: 28.10.2024	Date: 28.10.2024	Date: 28.10.2024
Drawing Number: 065167-SLR-XXX-XXX-DR-CH-020	Rev: P01	

