

This drawing is COPYRIGHT. It must not be reproduced or disclosed to third parties without our prior permission. Do not copy this drawing, or interrogate and use electronic information.

Any discrepancies should be reported immediately.

Any surveyed information incorporated within this drawing cannot be guaranteed as accurate unless confirmed by a fixed dimension. All dimensions are in millimetres unless noted otherwise.

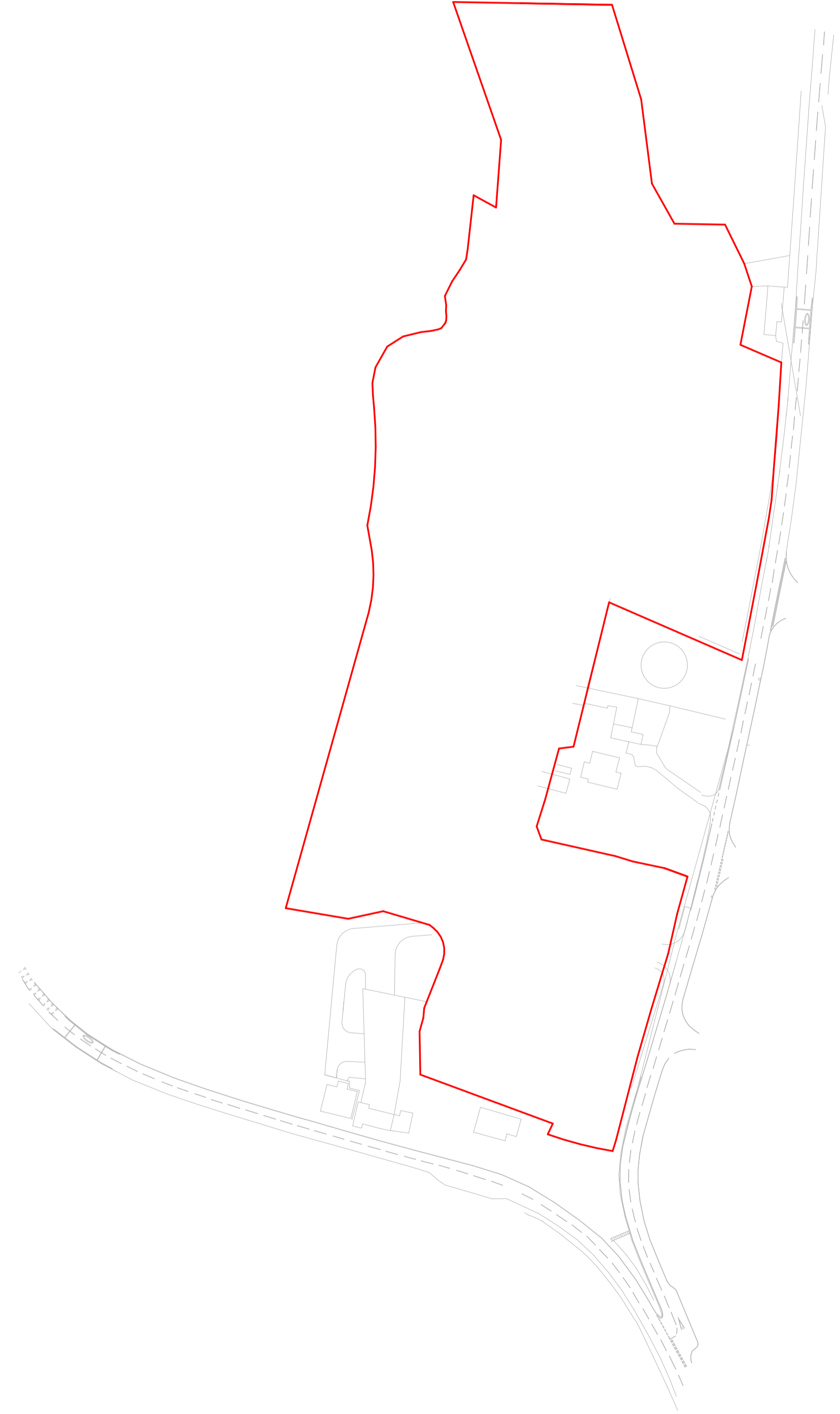

Application Site Boundary

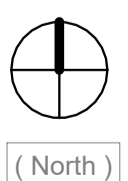

Location Plan

1 : 1250



Head Office
29 Broad Street
Newtown
Powys
SY16 2BQ
t - 01874 10311
w - www.hughesarchitects.co.uk

Project :- Proposed Residential Development adj. Forden Road, Montgomery, SY15 6QX			
Drawing Status :- Stage 3a		Drawing Title :- Location Plan	
Scale :- 1 : 1250	Date :- 14.08.24	Drawing No :- Z006.3a.1.001	Rev :- B
Drawn by :- KT	Checked :- OO		

B - Updated following final SLR plan - 12.11.24
A - KT - Revised Following Receipt of SLR Information - 01.10.24