

PLOT FINISHED FLOOR LEVELS ARE SUBJECT TO +/-600mm LEVEL CHANGE AT DETAILED DESIGN.

DWELLING ACCESS POINTS HAVE BEEN ADDED BUT ARE SUBJECT TO CONFIRMATION BY THE ARCHITECT.

- Key:
- Site boundary
  - 79.100 Finished floor level to house and garage
  - +79.10 Proposed finished level
  - 79.103 Proposed back of footpath level
  - 4 steps Steps

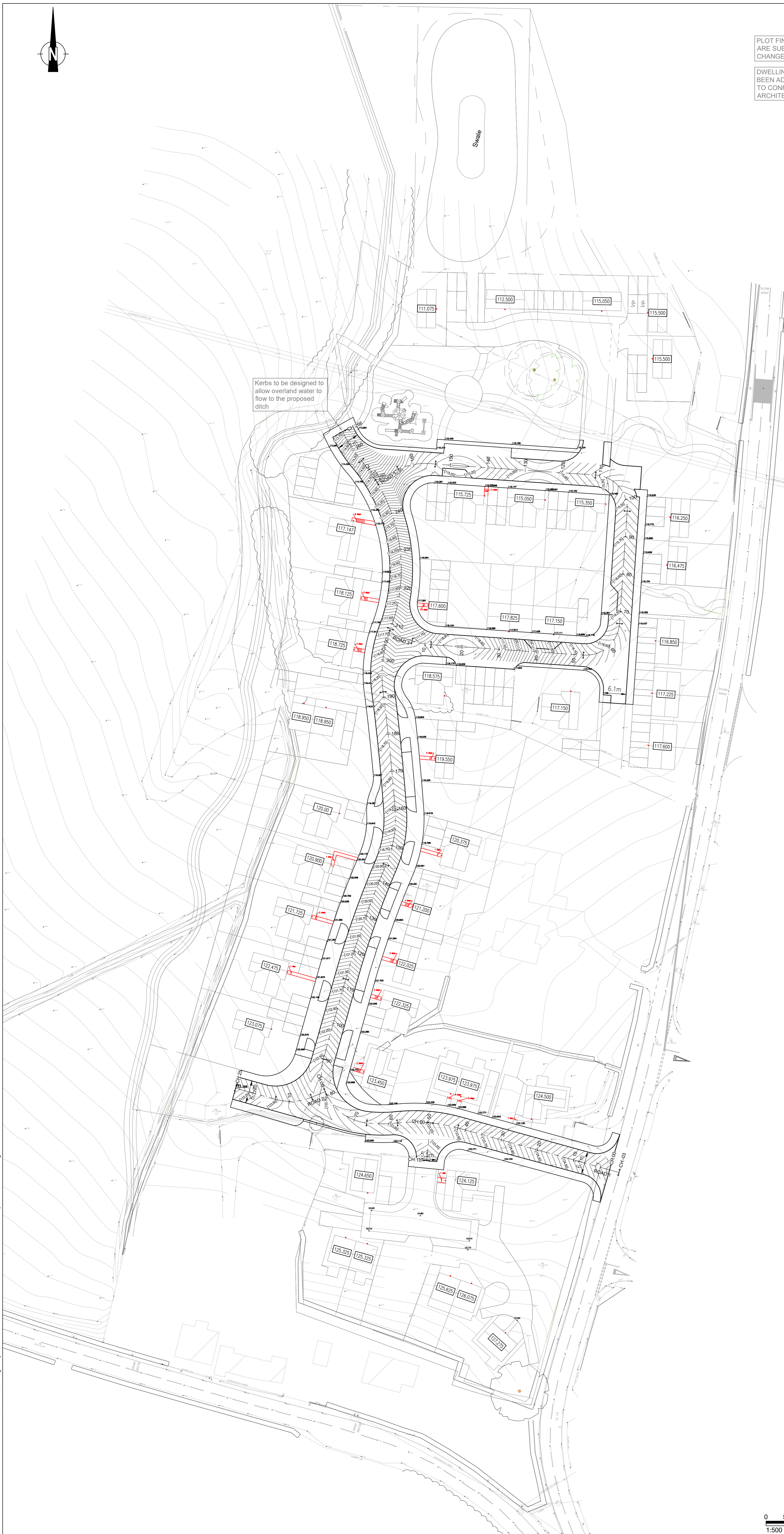

### AWAITING TECHNICAL APPROVAL

This drawing has NOT been technically approved by Local Authority and/or Water Authority. All works subject to change through technical review process with relevant approving authorities.

- SAFETY, HEALTH AND ENVIRONMENTAL INFORMATION**
- PLEASE REFER TO THE HEALTH AND SAFETY FILE FOR A FULL LIST OF THE HAZARDS ASSOCIATED WITH THIS WORK - THE FOLLOWING ARE THE MOST SIGNIFICANT ITEMS TO BE AWARE OF.
- CONSTRUCTION**
1. OPERATIVES TO TAKE PRECAUTIONS WHEN WORKING ADJACENT TO OR WITHIN DEEP EXCAVATIONS: METHOD STATEMENT TO BE PRODUCED BY CONTRACTOR PRIOR TO WORKS COMMENCING.
  2. ATTENTION IS DRAWN TO THE EXISTENCE OF BOTH EXISTING UNDERGROUND AND OVERHEAD UTILITIES.
- ENVIRONMENTAL**
1. EXISTING WATERCOURSES IN CLOSE PROXIMITY TO WORKS. A POLLUTION PREVENTION STRATEGY AND WORKING METHOD STATEMENTS TO BE PRODUCED BY THE CONTRACTOR FOR ALL WORKS.
  2. CONSIDERATION GIVEN TO NOISE LEVELS GIVEN PROXIMITY TO EXISTING PROPERTIES.
  3. CONSIDERATION GIVEN TO GROUND CONDITIONS: CONTRACTOR TO REVIEW GEOTECHNICAL REPORT PRIOR TO UNDERTAKEN EXCAVATION WORKS.
- WORK CAN ONLY BE CARRIED OUT BY SUITABLY TRAINED AND BRIEFED PERSONNEL.

P01	First issue	18.10.24	IO	JAK	JAK
Rev	Amendments	Date	By	Chk	Auth



[www.slrconsulting.com](http://www.slrconsulting.com)

Drawing Status & Suitability Code  
**FOR STAGE APPROVAL S4**

Client  
**POWIS ESTATES**

Project  
**LAND AT VERLON FARM  
 POOL ROAD  
 MONTGOMERY**

Drawing Title  
**PROPOSED LEVELS PLAN**

Scale  
**1:500 @ A1** SLR Project No.  
**416.065277.00001**

Designed IO	Drawn IO	Checked JAK	Authorised JAK
Date 07.10.2024	Date 07.10.2024	Date 07.10.2024	Date 07.10.2024

Drawing Number: **416.065277-SLR-XXX-XXX-DR-CE-0110** Rev: **P01**

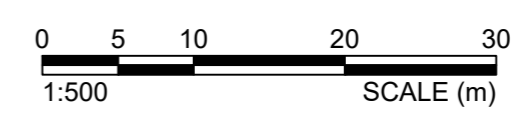

18/10/2024  
 I:\065277\2024\16.065277-SLR-XXX-XXX-DR-CE-0110-Proposed Levels Plan.dwg