

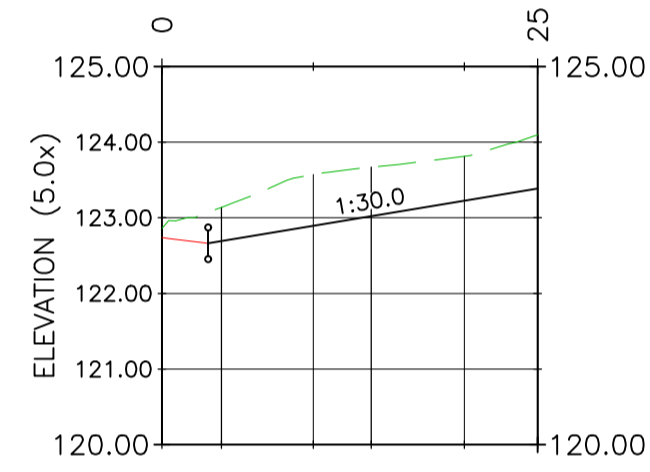

LONG SECTION: Road 2  
SCALE: H:500, V:100  
DATUM: 120.00

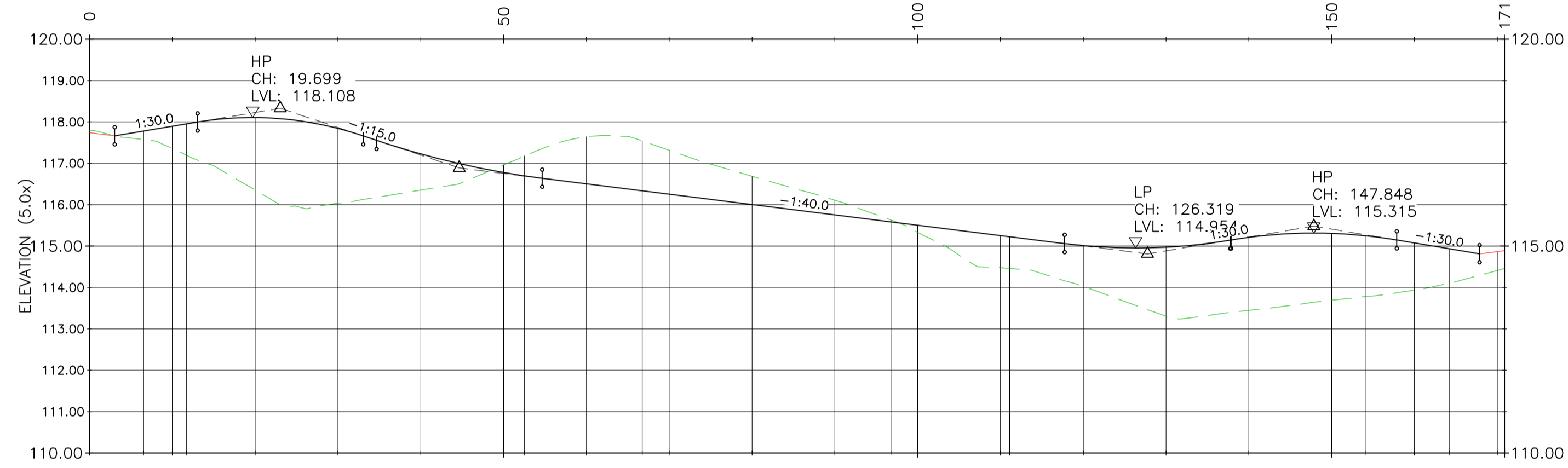

LONG SECTION: Road 3  
SCALE: H:500, V:100  
DATUM: 110.00



LONG SECTION: Road 1 TH  
SCALE: H:500, V:100  
DATUM: 120.00

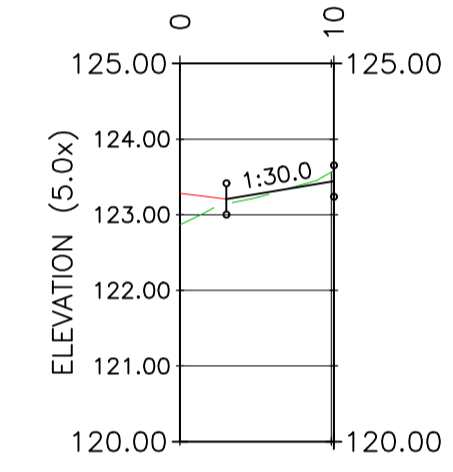

CHAINAGE	H: 10.000 V: 20.000
HORIZONTAL GEOMETRY	L:3.9 R:15.0 L:11.0 L:9.9
VERTICAL GEOMETRY	G:1:30.0 (3.3%) L:21.8
EXISTING LEVELS	123.572 123.814
FINISHED LEVELS	H: 122.691 V: 122.893 123.021 123.227 123.388

CHAINAGE	H: 10.000 V: 20.000	H: 30.000 V: 40.000	H: 60.000 V: 70.000	H: 90.000 V: 100.000	H: 120.000 V: 130.000	H: 150.000 V: 160.000	H: 170.000 V: 180.000		
HORIZONTAL GEOMETRY	L:6.5 R:20.0 L:5.2	L:40.8	R:9.1 L:14.2	L:30.1	R:9.0 L:14.2	L:42.9	R:18.8 L:10.2 L:6.7		
VERTICAL GEOMETRY	G:1:30.0 (3.3%) L:10.0	K:2.0 R:200.0 L:20.0	G:-1:15.0 (-6.7%) L:1.6	K:4.8 R:480.0 L:20.0	G:-1:40.0 (-2.5%) L:63.1	K:3.4 R:342.9 L:20.0	G:1:30.0 (3.3%) L:0.1	K:3.0 R:300.0 L:20.0	G:-1:30.0 (-3.3%) L:10.0
EXISTING LEVELS	117.358 117.355 116.034 116.351 116.961 116.639 117.642 117.316 116.689 116.110 115.332 114.481 114.024 113.307 113.446 113.691 113.936 114.457 114.510								
FINISHED LEVELS	H: 117.779 V: 117.895 117.996 118.107 118.080 117.842 117.663 117.556 116.993 116.778 116.697 116.639 116.505 116.337 116.255 116.005 115.755 115.583 115.505 115.255 115.061 115.012 114.957 114.857 114.974 115.148 115.212 115.315 115.307 115.251 115.148 115.076 114.937 114.815								

CHAINAGE	H: 10.000 V: 20.000
HORIZONTAL GEOMETRY	L:10.2
VERTICAL GEOMETRY	G:1:30.0 (3.3%) L:7.1
EXISTING LEVELS	123.563
FINISHED LEVELS	H: 123.208 V: 123.4539

**AWAITING TECHNICAL APPROVAL**

This drawing has NOT been technically approved by Local Authority and/or Water Authority. All works subject to change through technical review process with relevant approving authorities.

**SAFETY, HEALTH AND ENVIRONMENTAL INFORMATION**

PLEASE REFER TO THE HEALTH AND SAFETY FILE FOR A FULL LIST OF THE HAZARDS ASSOCIATED WITH THIS WORK - THE FOLLOWING ARE THE MOST SIGNIFICANT ITEMS TO BE AWARE OF.

- CONSTRUCTION**
- OPERATIVES TO TAKE PRECAUTIONS WHEN WORKING ADJACENT TO OR WITHIN DEEP EXCAVATIONS. METHOD STATEMENT TO BE PRODUCED BY CONTRACTOR PRIOR TO WORKS COMMENCING.
  - ATTENTION IS DRAWN TO THE EXISTENCE OF BOTH EXISTING UNDERGROUND AND OVERHEAD UTILITIES.

- ENVIRONMENTAL**
- EXISTING WATERCOURSES IN CLOSE PROXIMITY TO WORKS. A POLLUTION PREVENTION STRATEGY AND WORKING METHOD STATEMENTS TO BE PRODUCED BY THE CONTRACTOR FOR ALL WORKS.
  - CONSIDERATION GIVEN TO NOISE LEVELS GIVEN PROXIMITY TO EXISTING PROPERTIES.
  - CONSIDERATION GIVEN TO GROUND CONDITIONS. CONTRACTOR TO REVIEW GEOTECHNICAL REPORT PRIOR TO UNDERTAKEN EXCAVATION WORKS.

WORK CAN ONLY BE CARRIED OUT BY SUITABLY TRAINED AND BRIEFED PERSONNEL

P01	First Issue	18.10.24	IO	JAK	JAK
Rev	Amendments	Date	By	Chk	Auth



www.slrconsulting.com

Drawing Status & Suitability Code  
**FOR STAGE APPROVAL S4**

Client  
**POWIS ESTATES**

Project  
**LAND AT VERLON FARM  
POOL ROAD  
MONTGOMERY**

Drawing Title  
**HIGHWAYS LONG SECTIONS PLAN**

Scale  
**1:500 @ A1** SLR Project No.  
**416.065277.00001**

Designed	Drawn	Checked	Authorised
IO	IO	JAK	JAK

Date	Date	Date	Date
07.10.2024	07.10.2024	07.10.2024	07.10.2024

Drawing Number	Rev
<b>416.065277-SLR-XXX-XXX-DE-CH-0151</b>	<b>P01</b>

