

This drawing is COPYRIGHT. It must not be reproduced or disclosed to third parties without our prior permission. Do not scale from this drawing, or interrogate and use electronic information.

Any discrepancies should be reported immediately.

Any surveyed information incorporated within this drawing cannot be guaranteed as accurate unless confirmed by a fixed dimension. All dimensions are in millimetres unless noted otherwise.

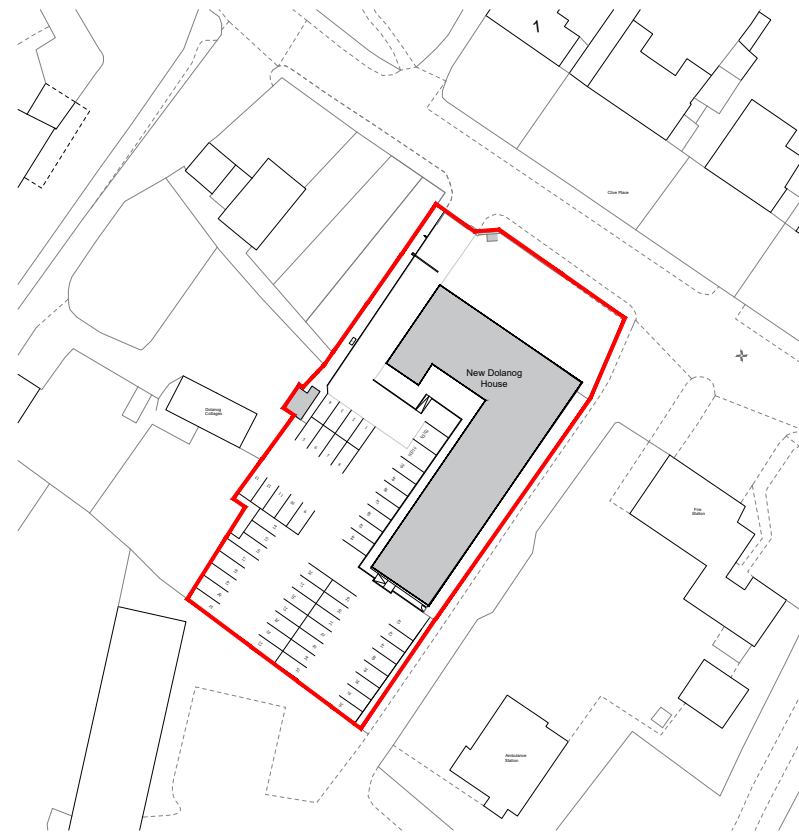

© Crown copyright 2022 Ordnance Survey 100053143



Application Site Boundary

Project Conversion of First and Second Floors to Residential Accommodation, Dolanog House, Severn Rd, Welshpool.	
Drawing Status Stage 3 Planning	Drawing Title Location Plan
Scale 1:1250@A3 Date 12.10.23	Drawing No XI 10.3a.3.001
Drawn by LW Checked RL DH	Rev A

Rev A - Amended as per planning comments 09.11.23 - LW

HUGHES
ARCHITECTS

Head Office
29 Broad Street
Newtown
Powys
SY16 2BQ
t - 01686 610311
w - www.hughesarchitects.co.uk